

- INSTALLATION ORDER:
1. LAY DOWN BASE SHEET PATCH, TURN DOWN AT FRONT NAILERS.
  2. LAY DOWN CAP SHEET PATCH, OVERLAP BASE SHEET BY 3½", DO NOT TURN DOWN AT EDGE.
  3. PLACE SCUPPER IN PLACE, SET IN APPROVED ADHESIVE AND NAIL PER SPECIFICATIONS.
  4. ROLL OUT BASE SHEET ON ROOF FIELD, CUT LINE AT INSIDE EDGE OF SCUPPER ONLY. BASE SHEET TURNED DOWN OVER EDGE TO COVER NAILERS
  5. ROLL OUT CAP SHEET. CUT LINE AT INSIDE OF SCUPPER ONLY,
  6. APPLY SEALANT TO ALL EXPOSED EDGES AT SCUPPER.
  7. INSTALL R-MER EDGE PER MANUF. SPECIFICATIONS ON EITHER SIDE OF SCUPPER.
  8. INSTALL SCUPPER COVER.

PREMANUF. SCUPPER PAN,  
SET IN ADHESIVE, NAILER PER  
SPECS. (SCUPPER COVER NOT  
SHOWN FOR CLARITY)[3]

BASE FRAME (SEALANT,  
COMPRESSION SEALS &  
FASCIA COVER NOT SHOW  
FOR CLARITY) [7]

SEALANT PER  
SPECIFICATIONS [6]

\*BASE FRAME NOT  
SHOWN THIS SIDE  
FOR CLARITY

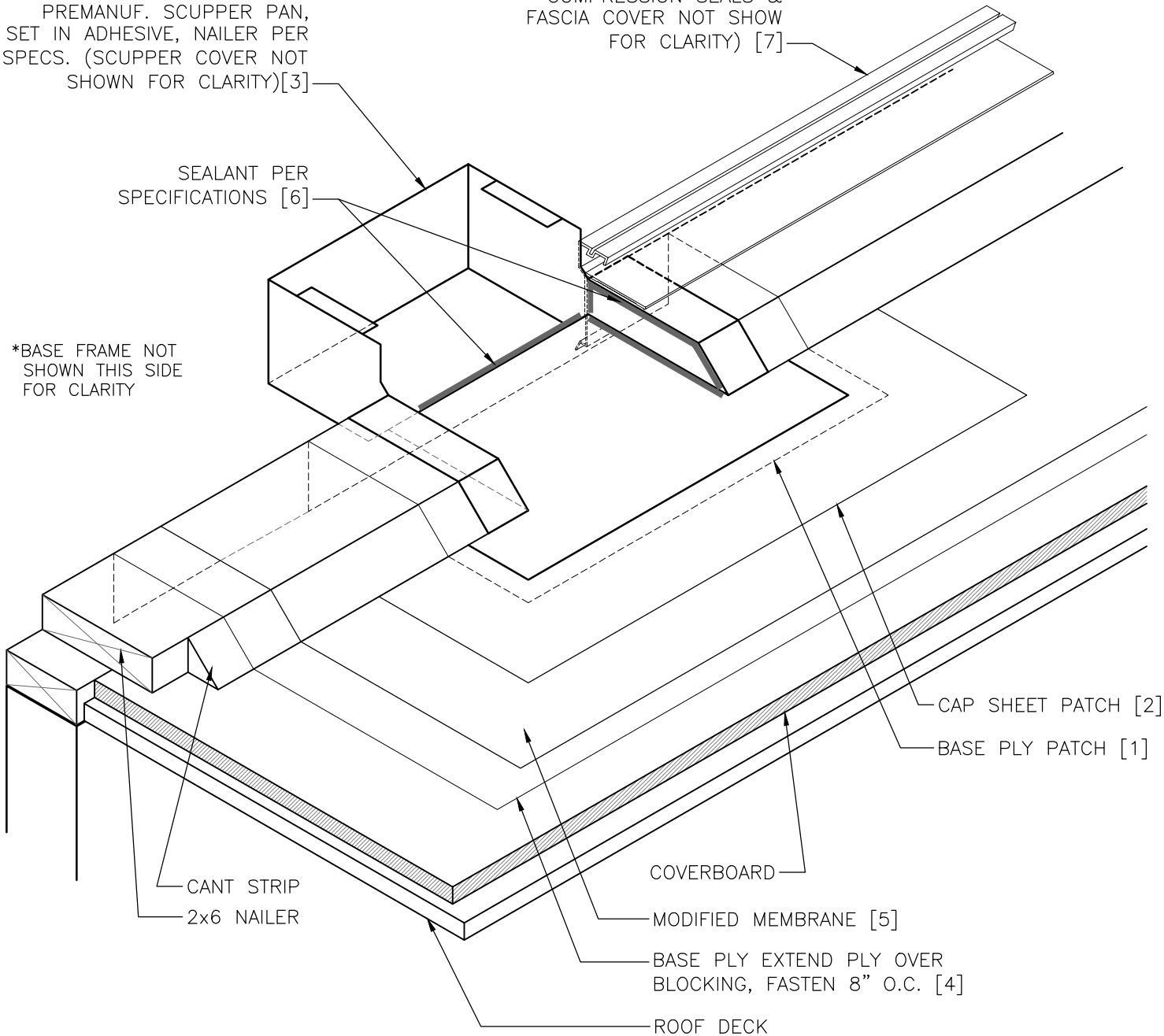

CAP SHEET PATCH [2]

BASE PLY PATCH [1]

CANT STRIP  
2x6 NAILER

COVERBOARD

MODIFIED MEMBRANE [5]

BASE PLY EXTEND PLY OVER  
BLOCKING, FASTEN 8" O.C. [4]

ROOF DECK

DRAWINGS ON 8½"x11 TITLE BLOCKS ARE NOT TO SCALE.

PREMANUFACTURED SCUPPER



THE GARLAND COMPANY, INC.  
GARLAND CANADA, INC.  
THE GARLAND COMPANY UK, LTD

PROJECT:	
CUSTOMER:	
ARCHITECT:	
REPRESENTATIVE:	
DATE:	SHT: OF